



EDELSTAHL / STAINLESS STEEL
VERBINDUNGSTECHNIK
FLUID CONNECTORS







Messanschlüsse Pressure Gauge Connectors



14

MESSANSCHLÜSSE

PRESSURE GAUGE CONNECTORS

	Produktgruppen	Product Groups	Seite Page
	Messanschlüsse	<i>Test Point Pressure Gauge Connectors</i>	14.2
	Gerade Messverschraubungen - GMV - Standard - SC - OMD	<i>Straight Test Point Pressure Gauge Fittings - GMV</i> - Standard - SC - OMD	14.3 14.4 14.5
	Messanschlüsse - VKA - DKO	<i>Test Point Pressure Gauge Connectors - VKA - DKO</i>	14.6
	Hochdruck-Messschläuche - SMS	<i>High Pressure Test Hoses - SMS</i>	14.7
	Manometer-Messanschlüsse - SMA	<i>Gauge Test Adaptors - SMA</i>	14.8
	Manometer-Direktanschlüsse - SMD	<i>Direct Gauge Adaptors - SMD</i>	14.9

Standard = Überwurfmutter blank / Tube nuts are supplied unplated
SC = Überwurfmutter bis Größe 12-S ist ist gleitbeschichtet / Tube nuts until size 12-L are supplied chemical plated
= Überwurfmutter ab Größe 12-S ist mit versilbertem Gewinde / Tube nuts from size 12-S are supplied with silver plated thread
OMD = Verschraubung ohne Überwurfmutter und Schneidring am Außengewinde / Couplings are supplied without nut and cutting ring at male thread

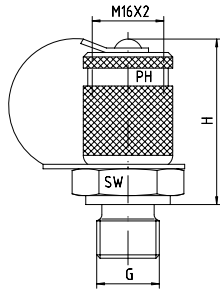

Mit Schraubkupplung M 16 x 2
O-Ring - Viton

With Connection M 16 x 2
O-ring - Viton

Druck Pressure PN	Gewinde Thread G	Ca. Maße Approx. Dimensions		Abdichtung Sealing	Bestellzeichen Order-Code	Brutto-Preis Gross-Price Euro (€)
		H	SW			
630	M 8 x 1	37	17	O-Ring Form A / O-ring Form A	MAS-M 8x1-or	48,06
630	M 10 x 1	37	17	O-Ring Form A / O-ring Form A	MAS-M 10x1-or	48,06
630	M 10 x 1	37	17	Weichdichtung Form C / Soft Sealing Form C	MAS-M 10x1-wd	50,10
630	M 12 x 1,5	37	17	Weichdichtung Form C / Soft Sealing Form C	MAS-M 12x1,5-wd	53,50
630	M 14 x 1,5	37	19	Weichdichtung Form C / Soft Sealing Form C	MAS-M 14x1,5-wd	48,06
630	M 16 x 1,5	37	22	Weichdichtung Form C / Soft Sealing Form C	MAS-M 16x1,5-wd	48,06

Druck Pressure PN	Gewinde Thread G	Ca. Maße Approx. Dimensions		Abdichtung Sealing	Bestellzeichen Order-Code	Brutto-Preis Gross-Price Euro (€)
		H	SW			
630	G 1/8"	37	17	Weichdichtung Form C / Soft Sealing Form C	MAS-G 1/8"-wd	48,06
630	G 1/4"	37	19	Weichdichtung Form C / Soft Sealing Form C	MAS-G 1/4"-wd	48,06
630	G 3/8"	40	22	Weichdichtung Form C / Soft Sealing Form C	MAS-G 3/8"-wd	52,85
630	G 1/2"	40	27	Weichdichtung Form C / Soft Sealing Form C	MAS-G 1/2"-wd	75,50

Druck Pressure PN	Gewinde Thread G	Ca. Maße Approx. Dimensions		Abdichtung Sealing	Bestellzeichen Order-Code	Brutto-Preis Gross-Price Euro (€)
		H	SW			
630	R 1/8" keg	36	17	Gewinde Form D / Thread Form D	MAS-R 1/8"-k	57,60
630	R 1/4" keg	36	17	Gewinde Form D / Thread Form D	MAS-R 1/4"-k	57,60

Druck Pressure PN	Gewinde Thread G	Ca. Maße Approx. Dimensions		Abdichtung Sealing	Bestellzeichen Order-Code	Brutto-Preis Gross-Price Euro (€)
		H	SW			
630	1/8" NPT	36	17	Gewinde Form D / Thread Form D	MAS-1/8"-NPT	57,60
630	1/4" NPT	37	17	Gewinde Form D / Thread Form D	MAS-1/4"-NPT	57,60
630	3/8" NPT	40	19	Gewinde Form D / Thread Form D	MAS-3/8"-NPT	68,50
630	1/2" NPT	40	22	Gewinde Form D / Thread Form D	MAS-1/2"-NPT	75,90

Form A

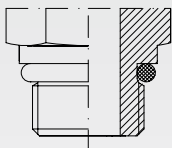

Abdichtung durch Runddichtung (O-Ring) - SAE J 514
Sealing by O-ring in Thread Undercut - SAE J 514

Form C

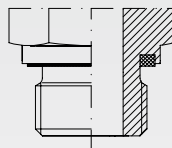

WD = Abdichtung durch gekammerte Profildichtung - Viton
WD = Sealing by an Elastomer Captive Profiled Ring - Viton

Form D

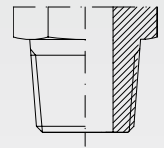

Abdichtung kegelig oder NPT
Sealing by Taper or NPT

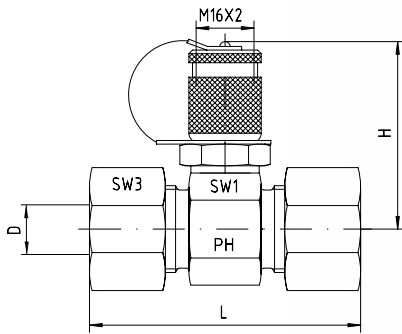

Mit Schraubkupplung M 16 x 2
O-Ring - Viton
Lieferung komplett mit Mutter und Schneidring

With Connection M 16 x 2
O-ring - Viton
Delivery complete with Nut and Cutting Ring

Reihe Series	Druck Pressure PN	Rohr A.D. Tube O.D. D	Ca. Maße Approx. Dimensions				Bestellzeichen Order-Code Standard	Brutto-Preis Gross-Price Euro (€)
			L	H	SW1	SW3		
L	315	6	50,5	49,5	24	14	GMV-L-06	124,75
L	315	8	50,5	49,5	24	17	GMV-L-08	125,25
L	315	10	52,5	49,5	24	19	GMV-L-10	126,25
L	315	12	52,5	49,5	24	22	GMV-L-12	127,75
L	315	15	54,5	52,5	30	27	GMV-L-15	129,25
L	315	18	56,5	53,5	32	32	GMV-L-18	131,25
L	160	22	60,5	55,5	36	36	GMV-L-22	138,75
L	160	28	60,5	58,0	41	41	GMV-L-28	181,50
L	160	35	68,5	60,5	46	50	GMV-L-35	281,20
L	160	42	70,5	65,0	55	60	GMV-L-42	357,50

Reihe Series	Druck Pressure PN	Rohr A.D. Tube O.D. D	Ca. Maße Approx. Dimensions				Bestellzeichen Order-Code Standard	Brutto-Preis Gross-Price Euro (€)
			L	H	SW1	SW3		
S	630	6	54,5	49,5	24	17	GMV-S-06	125,25
S	630	8	54,5	49,5	24	19	GMV-S-08	126,25
S	630	10	56,5	49,5	24	22	GMV-S-10	127,75
S	630	12	56,5	49,5	24	24	GMV-S-12	128,90
S	630	14	62,5	51,0	27	27	GMV-S-14	129,25
S	400	16	62,5	52,5	30	30	GMV-S-16	131,25
S	400	20	68,5	55,5	36	36	GMV-S-20	138,75
S	400	25	74,5	58,0	41	46	GMV-S-25	181,50
S	400	30	80,5	60,5	46	50	GMV-S-30	281,20
S	315	38	91,0	65,0	55	60	GMV-S-38	357,50

GERADE MESSVERSCHRAUBUNGEN STRAIGHT TEST POINT PRESSURE GAUGE FITTINGS

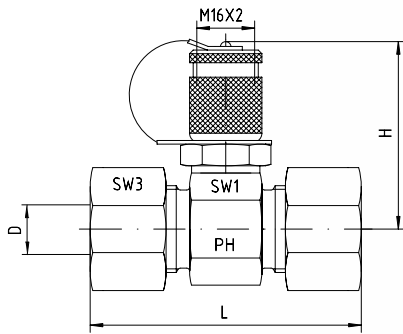

Mit Schraubkupplung M 16 x 2
O-Ring - Viton
Lieferung komplett mit Mutter und Schneidring

With Connection M 16 x 2
O-ring - Viton
Delivery complete with Nut and Cutting Ring

Reihe Series	Druck Pressure PN	Rohr A.D. Tube O.D. D	Ca. Maße Approx. Dimensions				Bestellzeichen Order-Code SC	Brutto-Preis Gross-Price Euro (€)
			L	H	SW1	SW3		
L	315	6	50,5	49,5	24	14	GMV-L-06-SC	125,39
L	315	8	50,5	49,5	24	17	GMV-L-08-SC	126,13
L	315	10	52,5	49,5	24	19	GMV-L-10-SC	127,13
L	315	12	52,5	49,5	24	22	GMV-L-12-SC	128,87
L	315	15	54,5	52,5	30	27	GMV-L-15-SC	131,41
L	315	18	56,5	53,5	32	32	GMV-L-18-SC	134,53
L	160	22	60,5	55,5	36	36	GMV-L-22-SC	142,03
L	160	28	60,5	58,0	41	41	GMV-L-28-SC	185,50
L	160	35	68,5	60,5	46	50	GMV-L-35-SC	288,64
L	160	42	70,5	65,0	55	60	GMV-L-42-SC	366,14

Reihe Series	Druck Pressure PN	Rohr A.D. Tube O.D. D	Ca. Maße Approx. Dimensions				Bestellzeichen Order-Code SC	Brutto-Preis Gross-Price Euro (€)
			L	H	SW1	SW3		
S	630	6	54,5	49,5	24	17	GMV-S-06-SC	126,13
S	630	8	54,5	49,5	24	19	GMV-S-08-SC	127,13
S	630	10	56,5	49,5	24	22	GMV-S-10-SC	128,87
S	630	12	56,5	49,5	24	24	GMV-S-12-SC	130,58
S	630	14	62,5	51,0	27	27	GMV-S-14-SC	132,37
S	400	16	62,5	52,5	30	30	GMV-S-16-SC	134,37
S	400	20	68,5	55,5	36	36	GMV-S-20-SC	134,99
S	400	25	74,5	58,0	41	46	GMV-S-25-SC	187,50
S	400	30	80,5	60,5	46	50	GMV-S-30-SC	289,52
S	315	38	91,0	65,0	55	60	GMV-S-38-SC	368,78



Mit Schraubkupplung M 16 x 2
O-Ring - Viton

With Connection M 16 x 2
O-ring - Viton

Reihe Series	Druck Pressure PN	Rohr A.D. Tube O.D. D	Ca. Maße Approx. Dimensions				Bestellzeichen Order-Code OMD	Brutto-Preis Gross-Price Euro (€)
L	315	6					GMV-L-06-OMD	120,13
L	315	8					GMV-L-08-OMD	119,65
L	315	10					GMV-L-10-OMD	119,53
L	315	12					GMV-L-12-OMD	119,97
L	315	15					GMV-L-15-OMD	118,97
L	315	18					GMV-L-18-OMD	114,01
L	160	22					GMV-L-22-OMD	118,13
L	160	28					GMV-L-28-OMD	151,80
L	160	35					GMV-L-35-OMD	238,98
L	160	42					GMV-L-42-OMD	302,64

Reihe Series	Druck Pressure PN	Rohr A.D. Tube O.D. D	Ca. Maße Approx. Dimensions				Bestellzeichen Order-Code OMD	Brutto-Preis Gross-Price Euro (€)
S	630	6					GMV-S-06-OMD	119,67
S	630	8					GMV-S-08-OMD	119,85
S	630	10					GMV-S-10-OMD	119,87
S	630	12					GMV-S-12-OMD	120,00
S	630	14					GMV-S-14-OMD	118,25
S	400	16					GMV-S-16-OMD	114,83
S	400	20					GMV-S-20-OMD	117,59
S	400	25					GMV-S-25-OMD	144,26
S	400	30					GMV-S-30-OMD	234,32
S	315	38					GMV-S-38-OMD	294,22

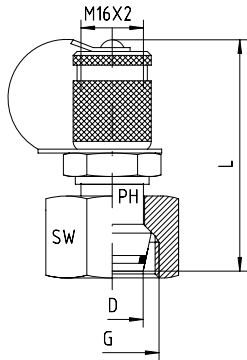

Mit Schraubkupplung M 16 x 2
Anschluss mit Dichtkegel und O-Ring - Viton
Passend in Bohrungsform W DIN 3861
Mit 24°-Konus

*With Connection M 16 x 2
Connection with Taper and O-ring - Viton
For Port End W DIN 3861
With 24°-Cone*

Reihe Series	Druck Pressure PN	Rohr A.D. Tube O.D. D	Gewinde Thread G	Ca. Maße Approx. Dimensions		Bestellzeichen Order-Code	Brutto-Preis Gross-Price Euro (€)
				L	SW		
L	315	6	M 12 x 1,5	72	14	VKA-DKOL-06	102,25
L	315	8	M 14 x 1,5	58	17	VKA-DKOL-08	102,25
L	315	10	M 16 x 1,5	58	19	VKA-DKOL-10	102,25
L	315	12	M 18 x 1,5	54	22	VKA-DKOL-12	79,25
L	315	15	M 22 x 1,5	57	27	VKA-DKOL-15	82,83
L	315	18	M 26 x 1,5	59	32	VKA-DKOL-18	90,50
L	160	22	M 30 x 2	60	36	VKA-DKOL-22	99,70
L	160	28	M 36 x 2	65	41	VKA-DKOL-28	107,40
L	160	35	M 45 x 2	70	50	VKA-DKOL-35	127,82
L	160	42	M 52 x 2	71	60	VKA-DKOL-42	166,15

Reihe Series	Druck Pressure PN	Rohr A.D. Tube O.D. D	Gewinde Thread G	Ca. Maße Approx. Dimensions		Bestellzeichen Order-Code	Brutto-Preis Gross-Price Euro (€)
				L	SW		
S	630	6	M 14 x 1,5	72	17	VKA-DKOS-06	102,25
S	630	8	M 16 x 1,5	58	19	VKA-DKOS-08	102,25
S	630	10	M 18 x 1,5	58	22	VKA-DKOS-10	102,25
S	630	12	M 20 x 1,5	54	24	VKA-DKOS-12	79,50
S	630	14	M 22 x 1,5	70	27	VKA-DKOS-14	82,83
S	400	16	M 24 x 1,5	55	30	VKA-DKOS-16	90,50
S	400	20	M 30 x 2	64	36	VKA-DKOS-20	99,70
S	400	25	M 36 x 2	66	46	VKA-DKOS-25	107,40
S	400	30	M 42 x 2	70	50	VKA-DKOS-30	128,90
S	315	38	M 52 x 2	72	60	VKA-DKOS-38	168,15



Mit Schraubkupplung M 16 x 2

With Metric Swivel End M 16 x 2

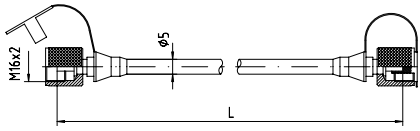

Druck Pressure PN	Schlauch Hose DN	Gewinde Thread	Länge Length L	Bestellzeichen Order-Code	Brutto-Preis Gross-Price Euro (€)
630	02	M 16 x 2	200	SMS-M-16-200	96,60
630	02	M 16 x 2	400	SMS-M-16-400	96,90
630	02	M 16 x 2	630	SMS-M-16-630	97,15
630	02	M 16 x 2	800	SMS-M-16-800	97,40
630	02	M 16 x 2	1000	SMS-M-16-1000	97,65
630	02	M 16 x 2	1500	SMS-M-16-1500	99,15
630	02	M 16 x 2	2000	SMS-M-16-2000	99,65
630	02	M 16 x 2	2500	SMS-M-16-2500	100,15
630	02	M 16 x 2	3200	SMS-M-16-3200	102,15
630	02	M 16 x 2	4000	SMS-M-16-4000	103,95

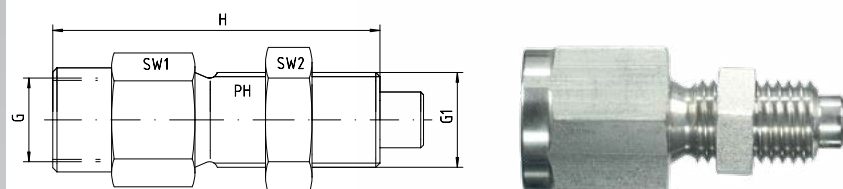

Innengewinde - Starr: BSP + NPT
Außengewinde: M 16 x 2
Dichtung: Viton

Female Thread: BSP + NPT
Male Thread: M 16 x 2
Sealing: Viton

Druck Pressure PN	Gewinde Thread		Ca. Maße Approx. Dimensions			Bestellzeichen Order-Code	Brutto-Preis Gross-Price Euro (€)
	G	G1	H	SW1	SW2		
630	1/4" BSP	M 16 x 2	50	19	19	SMA-20-G 1/4"-V	97,00
630	1/2" BSP	M 16 x 2	60	27	19	SMA-20-G 1/2"-V	126,77

Druck Pressure PN	Gewinde Thread		Ca. Maße Approx. Dimensions			Bestellzeichen Order-Code	Brutto-Preis Gross-Price Euro (€)
	G	G1	H	SW1	SW2		
630	1/4" NPT	M 16 x 2	50	19	19	SMA-20-1/4"-NPT-V	139,00
630	1/2" NPT	M 16 x 2	60	27	19	SMA-20-1/2"-NPT-V	196,00

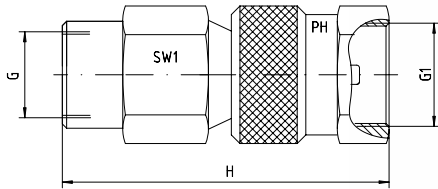

Innengewinde - Starr: BSP + NPT
Muttergewinde - Drehbar: M 16 x 2
Dichtung: Viton

Female Thread: BSP + NPT
Nut Female Swivel: M 16 x 2
Sealing: Viton

Druck Pressure PN	Gewinde Thread		Ca. Maße Approx. Dimensions		Bestellzeichen Order-Code	Brutto-Preis Gross-Price Euro (€)
	G	G1	H	SW1		
630	1/4" BSP	M 16 x 2	41	19	SMD-20-G 1/4"	96,43
630	1/2" BSP	M 16 x 2	51	27	SMD-20-G 1/2"	156,00

Druck Pressure PN	Gewinde Thread		Ca. Maße Approx. Dimensions		Bestellzeichen Order-Code	Brutto-Preis Gross-Price Euro (€)
	G	G1	H	SW1		
630	1/4" NPT	M 16 x 2	41	19	SMD-20-1/4"-NPT	119,00
630	1/2" NPT	M 16 x 2	51	27	SMD-20-1/2"-NPT	*

